

## **PROMOTER'S GUIDE**

The following documents provide information you may need in order to plan your event using our facilities.

**CONTACT INFORMATION (1)**

**ADDRESS AND DIRECTIONS (1)**

**TRUCK, BUS, VAN PARKING (2)**

**STAGE DIMENSIONS (3)**

**BAMA THEATRE PLAN VIEW (4)**

**FLY SYSTEM (5)**

**AUDIO (6)**

**LIGHTING/ELECTRICAL (7)**

**VIDEO (8)**

**EQUIPMENT (9)**

**DRESSING ROOMS (11)**

**SEATING CHARTS (12-13)**

**CHALLENGES & SOLUTIONS (14)**

**POLICIES, RULES & REGULATIONS (15)**

**PHOTOS (16-18)**

Visit us online at:  
**[www.bamatheatre.org](http://www.bamatheatre.org)**



# ADDRESS & DIRECTIONS

## MAILING ADDRESS

The Arts Council of Tuscaloosa  
PO BOX 1117  
TUSCALOOSA, AL 35403-1117

## SHIPPING ADDRESS

BAMA THEATRE  
(INCLUDE NAME OF ARTIST/ATTRACTION HERE)  
600 GREENSBORO AVE  
TUSCALOOSA, AL 35401

## PHYSICAL ADDRESS

600 GREENSBORO AVE  
TUSCALOOSA, AL 35401

Stage door is located half-way down the block on Greensboro Avenue. It is a large, double grey door marked clearly  
STAGE DOOR.

## DIRECTIONS TO THE BAMA

### From I-20/59/65:

Exit 71B towards Tuscaloosa. This becomes I-359 into Downtown Tuscaloosa. Come through downtown until you get to 6th Street (2nd to last street heading North), take a right. The Bama Theatre will be immediately on your right at the next light. Take a right on to Greensboro Avenue and the Stage Door is on your right.

### From Highway 82/Columbus, MS:

Turn right at Highway 69S/43S/11S. Come across the bridge and take a left at 6th Street (second intersection past bridge). Cross Lurleen Wallace Blvd and the Bama Theatre is on your right at the next right. Take a right on to Greensboro Avenue and the Stage Door is on your right.

### From Highway 82/Montgomery, AL:

Turn left onto Skyland Blvd. Go to the end of Skyland Blvd and take a right onto Highway 69N/43N. This becomes I-359. Come through downtown until you get to 6th Street (2nd to last street heading North), take a right. The Bama Theatre will be immediately on your right at the next light. Take a right on to Greensboro Avenue and the Stage Door is on your right.

## CONTACTS

### BAMA THEATRE MANAGER

Hannah Hall

bamatheatre@tuscarts.org  
205-758-5195 x5

### BOX OFFICE MANAGER

Grace Marachello

boxoffice@tuscarts.org  
205-758-5195 x1

### EXECUTIVE DIRECTOR OF THE ARTS COUNCIL

Sandra Wolfe

director@tuscarts.org  
205-758-5195 x3  
205-758-4994

### DIRECTOR OF EDUCATION

Autumn Fuller

education@tuscarts.org  
205-758-5195 x4

### MARKETING COORDINATOR

Grace Marachello

tuscartsmedia@gmail.com  
205-758-5195 x6

### PUBLIC RELATIONS

Nicholas Finch

pr@tuscarts.org  
205-758-5195 x6

### TECHNICAL DIRECTOR

David H. Jones

production@bamatheatre.com  
205-242-1935

# VEHICLE PARKING

## **PARKING AT THE BAMA**

There are four loading zone spaces directly in front of the Stage Door that have a timed limit of 30 minutes as well as 10, 2 hour timed spaces on the same block. There is parking on 3 of the 4 sides of the block housing the Bama Theatre. All street parking has a 2-hour limit and is regularly checked by the City.

The Bama Theatre can request spaces along Greensboro Avenue as well as 6th Street but the city requires 45 days advance notice and it is up to the city to grant the parking exceptions.

## **Intermodal Facility:**

The City of Tuscaloosa Intermodal Facility (IMF) is a three story parking deck two blocks away on 7th street that offers plenty of free parking spaces.

## STAGE DIMENSIONS

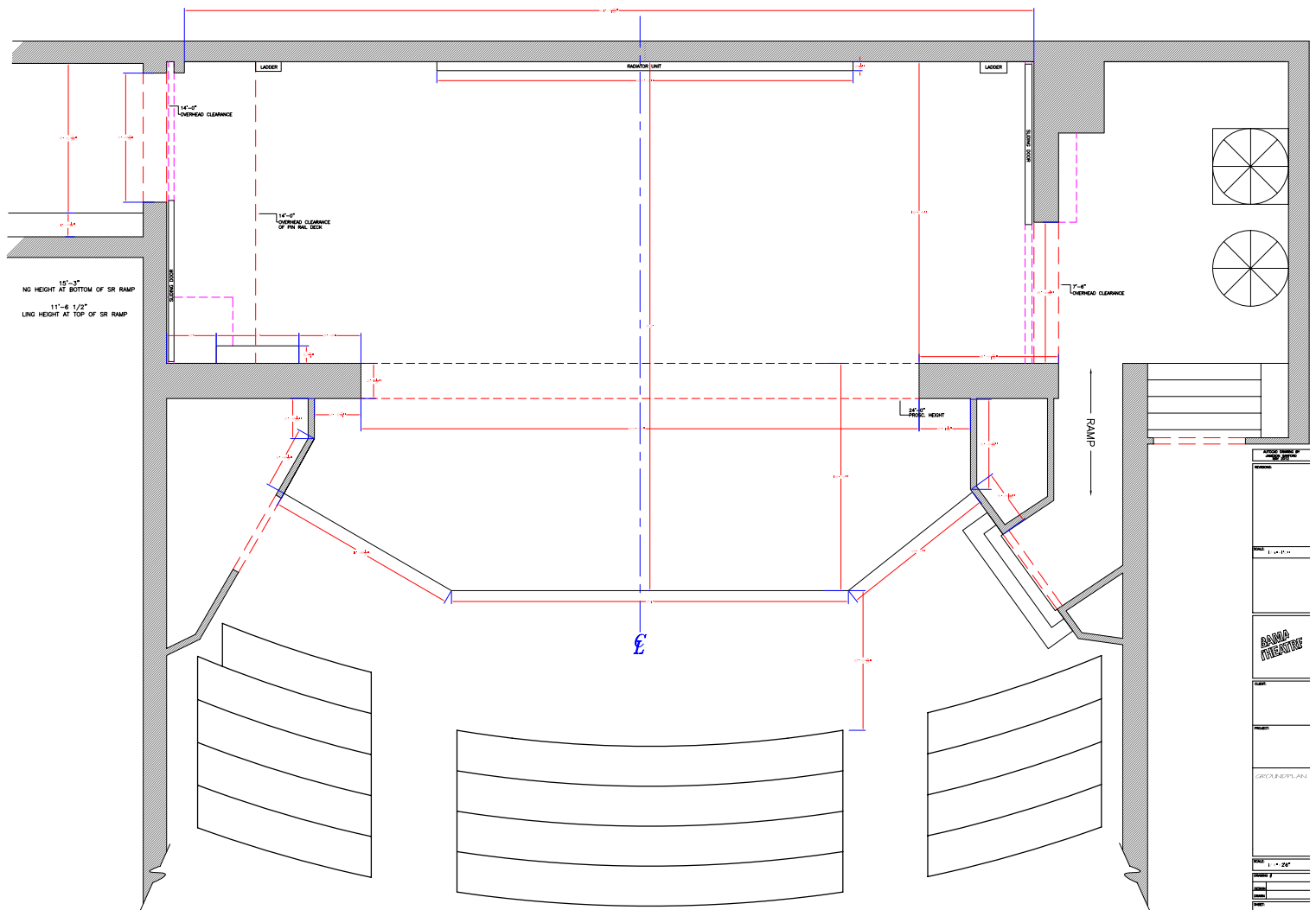

# BAMA THEATRE PLAN VIEW

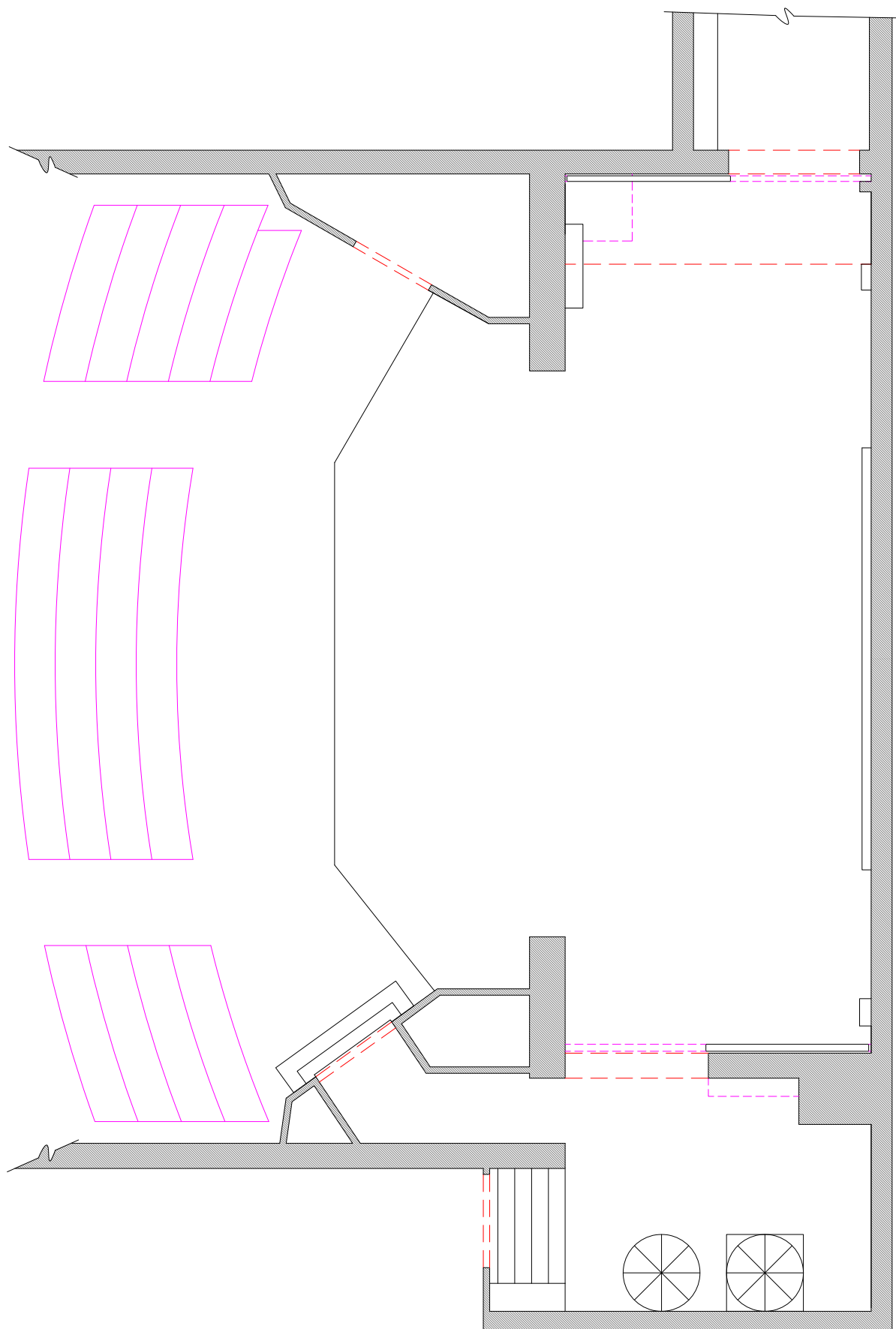

The Historic Bama Theatre - Tuscaloosa, Alabama

# FLY SYSTEM & RIGGING

## FLY SYSTEM INFORMATION

Double purchase counter weight system, fly rail stage right 14' above deck

There is NO loading gallery

15 line sets upstage of hard proscenium

Battens are ~40'w, 2" O.D. Schedule 40 pipe

There is enough pipe to bottom pipe three (3) 40' drops

Grid Height: 46'

Batten Highest Trim Height: 44'

Working height of battens: 39'

Lowest batten height off stage: 52"

Approximately 1,200lbs of weight available

## HOUSE LINESET SCHEDULE

DISTANCE FROM PLASTER LINE	LINE SET #	NORMAL HANG	MOVEABLE?
0'8"	1	Grand Teaser	Special Request
1'4"	2	Grand Drape	No
2'8"	3	Movie Screen	No
4'0"	4	1st Electric (6 x 2.4kw Circuits)	No
4'8"	5	9' x 24' DS Legs on 18' Traveler Track & Border	Legs can go to #4
6'8"	6	Open	
7'8"	7	2nd Electric (6 x 2.4kw Circuits)	No
8'6"	8	9' x 24' DS Legs on 18' Traveler Track & Border	
9'2"	9	Open	
10'6"	10	Cyc Lights (6 x 2.4kw Circuits)	No
11'10"	11	Open	
12'6"	12	Open	
13'10"	13	Star Curtain	Preferably Not
14'6"	14	Black (2x 40' x 24' Flat hung in full)	Yes
15'10"	15	Cyclorama (40' x 24')	Yes

## RIGGING DIAGRAM

Three runs of steel are available for rigging chain motors, baskets, etc.

### Motors Available with advanced noticed and for an additional fee:

3x CM Lodestar Model F 1/2 ton Chain Motors with 60' of chain

4x CM Lodestar Model L 1 ton Chain Motors with 60' of chain

6x CM/Coffing 1 ton 120v Chain Motors with 60' of chain

4 channel Skjonberg 3-phase motor control system is also available.

150' of Thomas 4-bolt 12" box truss is also available for additional fee and with advanced notice.

# AUDIO & COMM

## LINE ARRAYS & AMPS

Left/Right Stereo hang consisting of 5 EAW KF-730 & 1 EAW KF-737 per side.  
EAW UX-8800 4x8 system processor.  
6x Crown Macro-Tech 3600 amplifiers.

## HOUSE CONTROL

Digico SD-9 FOH console with 64 inputs, 16 outputs on stage, 8 inputs, 8 outputs at mix position.  
No digital monitor console available but analog with split snake can be requested with advance notice.

## MONITOR SPEAKERS & AMPS

8x JBL SRX-712m passive/bi-amp monitor speakers are available as well as 4 15" x 2" bi-amp cabinets running off a variety of Crown, QSC, and Mackie amplifiers via Ashley 4x2-way crossover.  
2x EAW KF-300z passive/bi-amp speakers as side-fills are permanently setup just down stage of the proscenium but can be moved or removed.

## FRONT FILLS/DELAY FILLS

5x EAW JF50  
2x EAW JF60  
4x EAW JF80

## CLEAR-COM

Single channel Clear-Com system with 4 fixed positions (Balcony rail, Back of Theatre, Stage Right, and Stage Left), 8 belt-packs available on request. 4 Clear-Com FreeSpeak-II wireless beltpacks available for an additional fee.

## MICROPHONES & PLAYBACK

A large assortment of microphones (wired and wireless systems) and playback devices are available upon request.

1x Sennheiser e902  
3x Sennheiser e604  
2x Shure SM 98-D  
2x Shure Beta 52  
1x Shure Beta 91  
1x Sennheiser MD-409  
2x Audio Technica 4040  
1x AKG C4140-TL ii  
5x AKG 451  
6x Shure SM 58  
10x Shure SM 17  
8x Sennheiser G3 Wireless Systems with 835, 845, 935 capsules  
2x Shure ULX-P Wireless Systems with 58 and Beta 87 capsules  
20x Sennheiser G3 Wireless Body Pack Systems with variety of Countryman, DPA, Sennheiser mics

# LIGHTING & ELECTRICAL

## ELECTRICAL SERVICE POWER

200A 3-phase @ SR Wall on Stage (shares power with in-house PA)

200A 3-phase off SL wing (typical lighting/video) - cam-lock tails attached and available.

100A 3-phase distro is available for a fee upon request.

3x 110v Nema-15 (edison) and stage pin

4x 110v L6-20 twist-lock

7x 208v L6-20 connections

1x 208v L6-30 connection

## DROP POWER & QUAD BOXES

There are numerous and varying length 110v quad box and stringers as well as a few 208v drop boxes available upon request.

Stage right audio distro has 16x 110v edison outlets spread over 4 circuits for band/stage power.

## LIGHTING CIRCUITS

All dimming circuits are L5-20 Twistlock. Most dimming lighting circuits are doubled-up. There are 96 total dimming circuits in the following locations:

8x House Right Balcony Box Boom (1-8)

8x House Left Balcony Box Boom (9-16)

8x House Right Mid-House Box Boom (17-24)

8x House Left Mid-House Box Boom (25-32)

8x House Right Stage Box Boom (33-40)

8x House Left Stage Box Boom (41-48)

6x 1st Electric (49-55)

6x 2nd Electric (56-60)

6x 3rd Electric (cyc lights) (61-66)

6x Stage Right Proscenium (67-72)

6x Stage Left Proscenium (73-78)

3x Upstage Left Back Wall (78-81)

3x Upstage Right Back Wall (82-85)

10x FOH Truss (86-96)

ETC Sensor dimmer with 96 2,400w channels. Dimmer is located just off stage right in dimmer closet.

Additional ETC Sensor dimmer with 24 2,400w channels available on-site upon request from a third-party vendor. 2 additional 12 x 2,400w ETC Sensor racks are also available for an additional fee.

There are 3 permanently hung stage electrics. The 1st and 2nd electric have intelligent movers permanently installed with very little room to add additional lighting. Electric 3 contains 4x 4-cell Altman Sky Cyc lights with 1000w lamps installed.

The in-house lighting fixtures and plot have been chosen and designed to fill the needs for the vast majority of shows that come through The Bama. You will be hard pressed to find a more suitable and capable rep plot in a theatre of this size.



# LIGHTING INVENTORY

\*Please contact our Technical Production Manager (production@bamatheatre.com) to discuss usage of the intelligent fixtures as they belong to a third party, independent production company.

## HOUSE LIGHTING CONTROL

GrandMA2 Lite capable of 4096 parameters with 6 outputs.

3 GrandMA NPU for an additional 12,288 parameters available upon request.

1 GrandMA NSP-2 for an additional 2048 parameters available upon request.

DMX to ART-Net converter available for 1 universe.

## DIMMING

ETC Sensor dimmer with 96x 2,400w channels - House installed

ETC Sensor dimmer with 24x 2,400w channels available for additional fee.

2x ETC Sensor dimmer with 12x 2,400w channels available for additional fee.

## CONVENTIONAL FIXTURES

24x ETC Source4 750w - 26 degree

6x ETC Source4 750w - 19 degree

6x ETC Source4 750w - 36 degree

4x ETC Source4 750w - 50 degree

6x ETC Source4 575w - 26 degree

16x ETC Source4 Par - all lenses available

## FOLLOWSPOTS

1x ETC Source4 750w - 19 degree on City Theatrical Yoke and Time Square Lighting Iris at Balcony Rail

1x ETC Source4 750w - 19 degree on tripod stand and Time Square Lighting Iris at Balcony Rail

1x Lycian 1240w Arc Spot in Projection Booth approx 90' from stage.

## INTELLIGENT FIXTURES AVAILABLE\*

6x Elation Artiste Monet Spot

8x Robe BMLF Blade Spot

4x Chauvet Legend 330sr Spot

10x Martin Rush MH4 Beam

15x GLP Impression X4 LED Wash

14x GLP Impression X4s LED Wash

6x TMB Solaris Flare LED Strobe/Wash

6x Ayrton MagicPanel 602

10x Ayrton MagicBlade R

8x Robe Spikie

8x Ayrton MagicDot

18x ETC Source4 Lustr Series2 LED Leko

16x Astera Titan Tubes FP1 w/ 1x CRMX DMX Box

8x JB LED A7 Led Wash (Martin Mac 301s)

18x Elation SixPar 300 IP LED Wash

4x Chromlech Jarag-5, 25x 60w matrix blinders

17x Chauvet Colorband Pix-M LED Bars (7x 12 cell, 10x 10 cell)

5x SGM X-5 Strobes

8x Chauvet Colorado 1 Tour IP LED Wash

3x Chauvet Colorado 1 Tour LED Wash

2x Chauvet Festoon Controllers with 5x 15m Strings with 20x RGB LED Bulbs (120 LED bulbs total)

12x Chauvet SlimPar Tri-12 BT LED Wash

4x Chauvet SlimPar Tri-7 LED Wash

## ATMOSPHERICS

2x Ultratec Radiance Hazer

1x Martin Jem Glaciator Extreme

1x Chauvet Amhaze Whisper Hazer

2x Chauvet Nimbus Dry Ice Foggers on Carts

2x Chauvet Cumulous Low Lying Foggers

3x Chauvet Vesuvio RGBA Foggers

1x Antari Fogger

1x Look Solutions Tiny Fogger S

**BOLD indicates some or all is part of rep plot**

# VIDEO

\*Please contact our Technical Production Manager to discuss usage of LED Wall as it belongs to third party, independent production company.

## **LED WALL\***

190x Absen A5 5.2mm Indoor 1/2m x 1/2m LED Panels capable of creating an LED Wall up to 32'x17' or 35'x14'.

NovaStar VX6S processing with VGA, DVI, SDI, HDMI inputs.  
Single and Double hanging bars available.

36x Infiled 3.9mm Indoor 1m x 1/2m LED Panels.  
NovaStar VX6S processing with VGA, DVI, SDI, HDMI inputs.  
Single and Double hanging bars available.

## **PROJECTION**

1x Panasonic, 5500 lumen projector is available on balcony rail for an additional cost.  
1x Eiki LC-X80, 6500 lumen projector is available for an additional cost. This projector has a shorter throw lens than the Panasonic.

Both projectors have VGA, DVI, Component inputs.

## **PROJECTION SCREENS**

1x 40' x 20' Cinema Screen on lineset #3 is available for an additional cost and with prior approval.  
1x 16' x 16' front projection screen to be hung on open lineset is available for an additional cost.  
1x 12' x 9' front projection screen to be hung on open lineset or used free-standing is available for an additional cost.  
1x 8' x 6' front projection screen to be hung on open lineset or used free-standing is available for an additional cost.

## **MEDIA SERVERS**

Resolume Arena Media Server Software and/or Arkaos MediaMaster Express Media Server Software is available upon request for an additional fee.

Playback laptop is available upon Laptop can be provided by show or our third party production house.

# DRESSING ROOMS

## DRESSING ROOMS

There are a total of 8 dressing rooms spread out on both sides of the stage. There are mirrors, counters, custom shelving and hanging racks in every dressing room. There is one shared shower and two shared bathrooms stage right. There are NO bathrooms or sinks stage left.

	CARPETED	SINK	TOILET	ACCOMODATES	LOCATION	FLOOR
#1	YES	YES	YES	1-2	SR	1
#2	NO	NO	NO	16	SR	1
#3	NO	NO	NO	20	SR	1
#4	NO	NO	NO	4	SL	2
#5	NO	NO	NO	5	SL	2
#6	NO	NO	NO	5	SL	2
#7	NO	NO	NO	4	SL	3
#8	NO	NO	NO	5	SL	3

## GREEN ROOM

Green Room is stage right and has comfortable seating for 12 with room for provided chairs. Tables for hospitality and a medium sized drink refrigerated cooler is also provided.

No laundry service exists at the Bama Theatre.

## PRODUCTION OFFICE

Included in the 8 dressing rooms above, #1 is often used as the “Star” dressing room or Production Office. It is closest to the stage, has a locking door and bathroom and sink.

# SEATING CHARTS

## TOUR PRODUCTION SEATING CHART

Tour production FOH location resides in the normally ADA reserved area House Left.

**BAMA  
THEATRE**

600 Greensboro Ave.  
Tuscaloosa, AL 35401  
www.bamatheatre.org

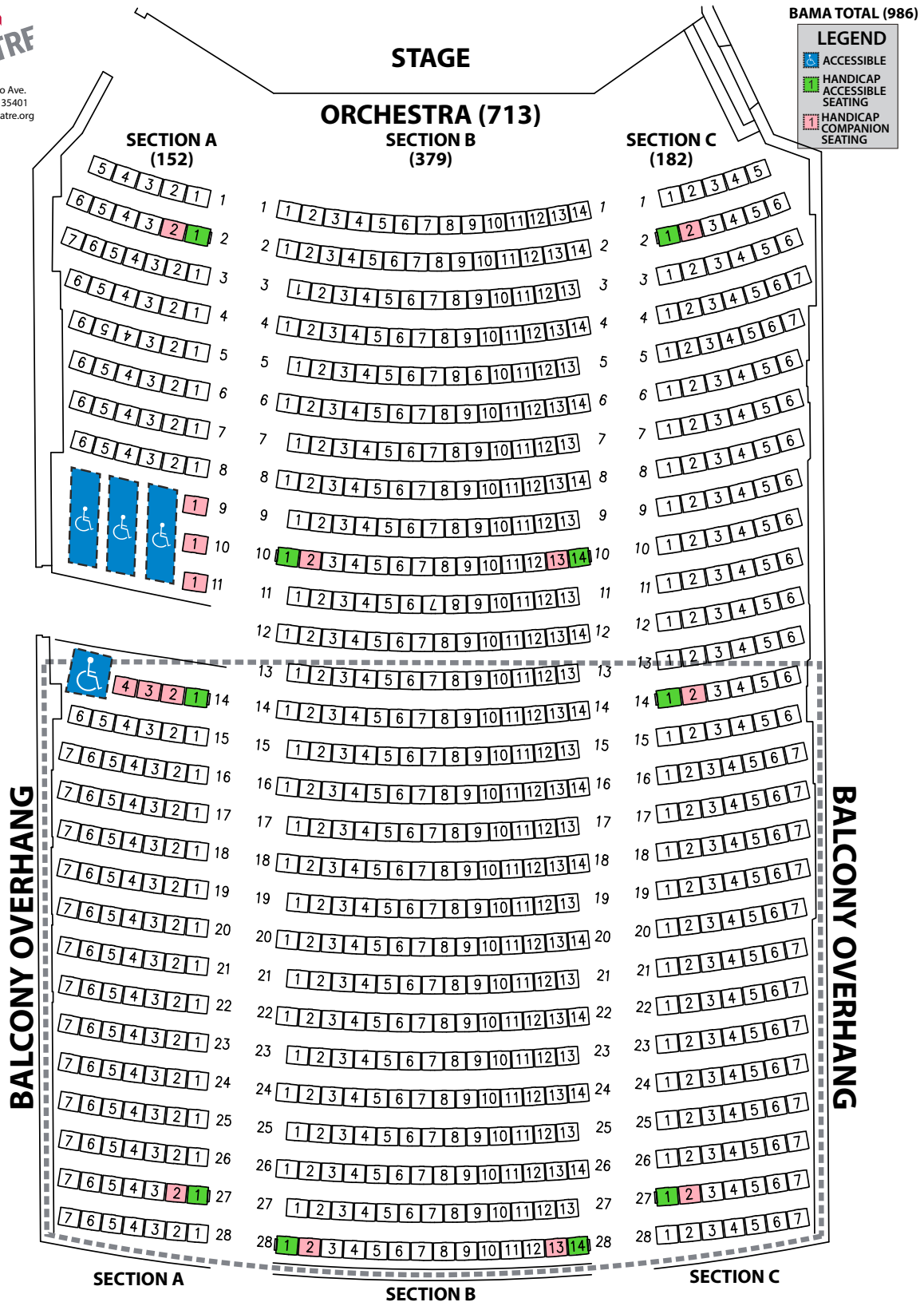

# SEATING CHARTS

## BALCONY SEATING CHART

**BAMA**  
THEATRE

600 Greensboro Ave.  
Tuscaloosa, AL 35401  
www.bamatheatre.org

### BALCONY (273)

#### LEGEND

**5** LIMITED VIEW

#### SECTION A (56)

#### SECTION B (140)

#### SECTION C (77)

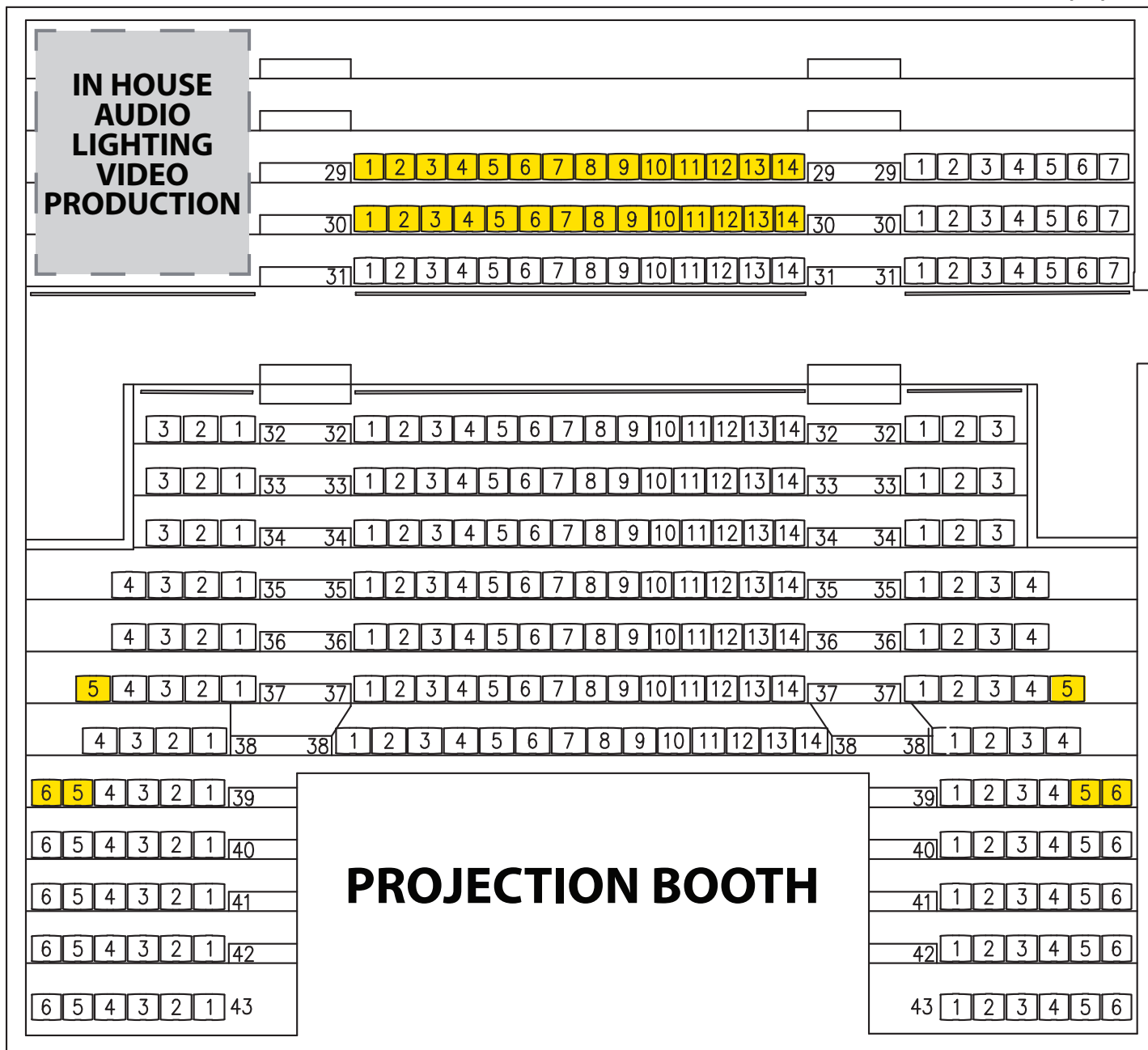

\* No Additional Seating Will Be Added To This Seating Chart \*

# CHALLENGES & SOLUTIONS

The Bama Theatre was built in 1938, opened in 1938, and renovated in the 1970s with the addition of the thrust stage. Throughout most of its existence, it has served the community as a venue for our resident theatre groups, local Dance studios, and touring events. As touring shows have gotten bigger and more complex, the staff at the Bama Theatre, in conjunction with touring show crews, has devised solutions to some of the challenges that have arisen over the years. For the majority of productions touring today, the Bama Theatre can be a workable venue without sacrificing the quality or quantity of the show's scenic elements. Following is a list of challenges, and the solutions that have been employed to overcome them:

## **GRID HEIGHT - 45': Drop Height Limitations and Pick Points**

The Bama Theatre has enough hardware in stock to hang four drops with a bottom 1" pipe at the bottom. The proscenium opening is 24' x 33' and we usually advise our renters to get drops measuring 40' x 24' with 20' being the absolute minimum height. Because the maximum height a drop can be flown out is not double the proscenium height, borders are used to mask the bottom of the upstage drops when flown out.

There are only 3 "pick" points in which to dead hang motors, steel, etc. These are stage center, just inside the stage left proscenium, and just inside the stage proscenium plaster. These are also notated on the blue-prints diagram above. Most three points are well spaced for a 40' span of truss hung via 3 motors. They are spaced well for a 20' section offset stage left or right as well.

**NOTE:** a 30' section of truss will not fit between all 3 points.

## **OFF STAGE WING SPACE**

As the Bama Theatre was initially built as a movie house, off stage space is very limited. With the renovation in 1970, expanded space stage right was created and is shared among the dressing rooms and production office. The large opening stage right measures 13' high by 14' wide. This is generally suitable for most set pieces. The limiting factor is the adjoining ramp that runs to the elevated backstage area. Because of the rake of this ramp, the maximum height for a set piece is limited to 10'2" tall. The wing space stage left is fairly narrow but through a 7'2" tall, 8' wide opening, more space can be gained. This also serves as access to the 5 stage left, upstairs dressing rooms. Stage left wing space is extremely tight upstage as this opening starts mid-stage.

## **STORAGE SPACE**

Storage space is at a premium backstage. There are no dedicated storage rooms or closets. The only two locations for storing dead cases, hampers, etc are the elevated/ground level stage right space next to the Green Room and the small area adjoining stage left which also doubles as a fire escape so consideration has to be made to leave this area accessible by patrons.

## **SIGHT LINE ISSUES CAUSED BY BALCONY RAIL**

As previously mentioned, the Bama Theatre was initially built as a movie house and did not have its current thrust style stage. The balcony rail obstructs much of the thrust portion of the stage, especially in the lower mezzanine section. Rows higher than 31 have a less obstructed view but the rail still cuts off the downstage most portion of the stage. Most events set their performance back 3-4' upstage which alleviates this issue if balcony seating is going to be utilized.

These solutions have proven themselves worthy on many occasions. However, new challenges arise every season and we are always eager to work with the touring show staff to find new solutions. If your show has particular needs or problems that should be addressed, please call the Technical Director well in advance of your show dates. We will be glad to assist in making your visit to the Bama Theatre a successful one.

# **POLICIES, RULES & REGULATIONS**

In order to assist our users, the following list of Policies, Rules & Regulations is provided to answer the most frequent inquiries regarding the Bama Theatre's policies. Much more information is provided in the Bama Theatre rental packet.

## **GENERAL INFORMATION**

The Bama Theatre is a non-smoking facility. In accordance with Section 14.97 of the Municipal Code of the City of Tuscaloosa. Additionally, The Bama Theatre prohibits the use of E-cigarettes inside its facilities. With approval of the Arts Council of Tuscaloosa in writing, an area may be designated outside as a smoking area for private events.

## **PARKING**

The City of Tuscaloosa's Intermodal Facility (IMF) located two blocks down 7th Street is free parking for passenger cars, vans, and other vehicles limited to 6' 2" high. No prior authorization is required to park in this deck. Greensboro Boulevard and surrounding streets are monitored by Tuscaloosa Parking Services and are free for 2 hours but must be moved to avoid ticketing. Parking is not monitored after 5pm Monday - Friday.



# PHOTOGRAPHS

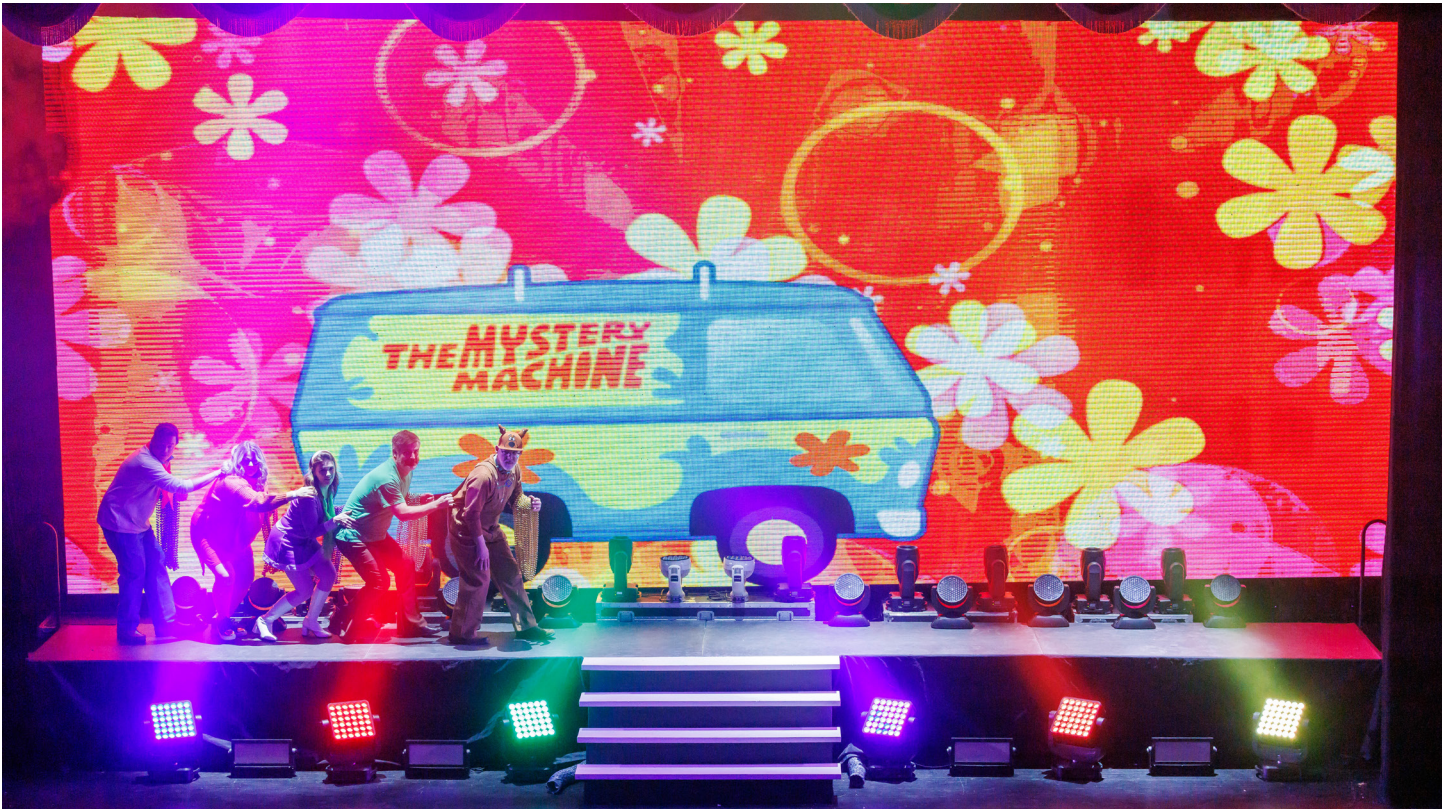

In this photo: 190x Absen A5 LED Panels, 6x Ayrton MagicPanel 602, 10x Martin Rush MH-4, 12x Martin Mac 301, 2x GLP Impression X4, 4x SGM X-5 Strobe



In this photo: 8x Martin Rush MH4 Beam, 10x JB LED A7, 11x Chauvet Legend 330sr Spot, 6x Chauvet Colorband Pix-M, 4x Chauvet Colorand 1 Tour, 1x 16' x' 16' Front Projection Screen, FOH Truss with Lekos

The Historic Bama Theatre - Tuscaloosa, Alabama



# PHOTOGRAPHS



In these photos: 12x Astera Titan Tube, 14x GLP Impression X4s, 12x Chauvet Legend 330sr, 12x GLP Impression X4, 6x Chauvet ColorBand Pix-M, 4x Jarag-5, 10x Martin Rush MH4 Beam, 2x Chauvet Vesuvio RGBA Fogger, 5x SGM X-5 Strobe, 190x Absen A5 LED Panels



The Historic Bama Theatre - Tuscaloosa, Alabama



# PHOTOGRAPHS



Newly renovated Historic Bama Theatre with new seating, new polished concrete, and new custom designed carpet.